

**MOUNTAIN VIEW RECREATION CENTER & LAKEVIEW RECREATION CENTER**  
PRELIMINARY SITE USE PLANS

**MOUNTAIN VIEW RECREATION CENTER  
SITE USE PRIORITIES DIAGRAM**

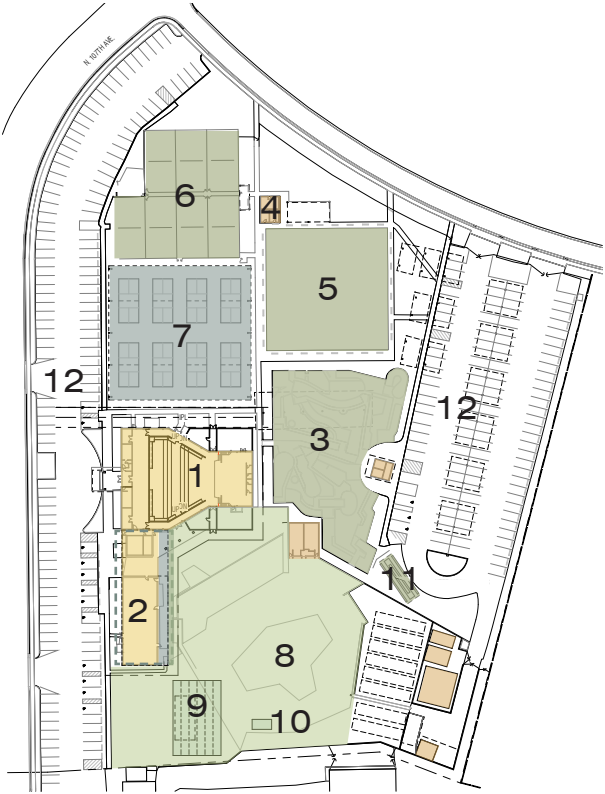

**PROJECT KEY**

- 1 Existing auditorium to be renovated
- 2 Existing showers / fitness to be renovated, add new recreation center above
- 3 Existing mini golf building to remain
- 4 Existing lawn bowling building to remain
- 5 Lawn Bowling to Remain
- 6 Pickleball to Remain
- 7 Pickleball - New Shaded / Vented
- 8 Keep Existing Resort / Aqua Fitness Pool
- 9 Lap / Sport Pool
- 10 Outdoor Spa
- 11 Horseshoes to Remain
- 12 Parking to remain

- Existing building to remain
- Existing building to be renovated
- New proposed structure zone
- Existing site amenity to remain
- New site amenity zone

**MOUNTAIN VIEW RECREATION CENTER  
RENOVATION AND ADDITION ZONES FOR THEATER**

The Mountain View Recreation Center will be renovated and added on to in order to create the spaces necessary to provide for the site priority uses. This will include renovating the existing fitness and restrooms to provide new locker rooms and adding a second level to create a new fitness zone. The existing auditorium would be renovated to be used as a performing arts theater seating approximately 320-340.

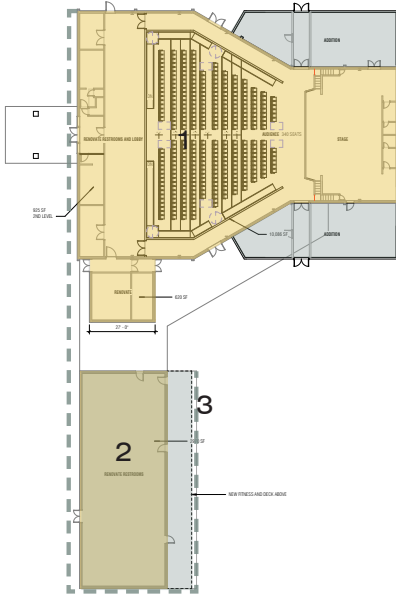

FLOOR PLAN DIAGRAM  
NTS

**PROJECT KEY**

- 1 Existing auditorium to be renovated
- 2 Existing showers / fitness to be renovated
- 3 New fitness zone above

- Existing building to be renovated
- New proposed structure zone
- New proposed structure zone overhead

**LAKEVIEW RECREATION CENTER**  
SITE USE PRIORITIES DIAGRAM

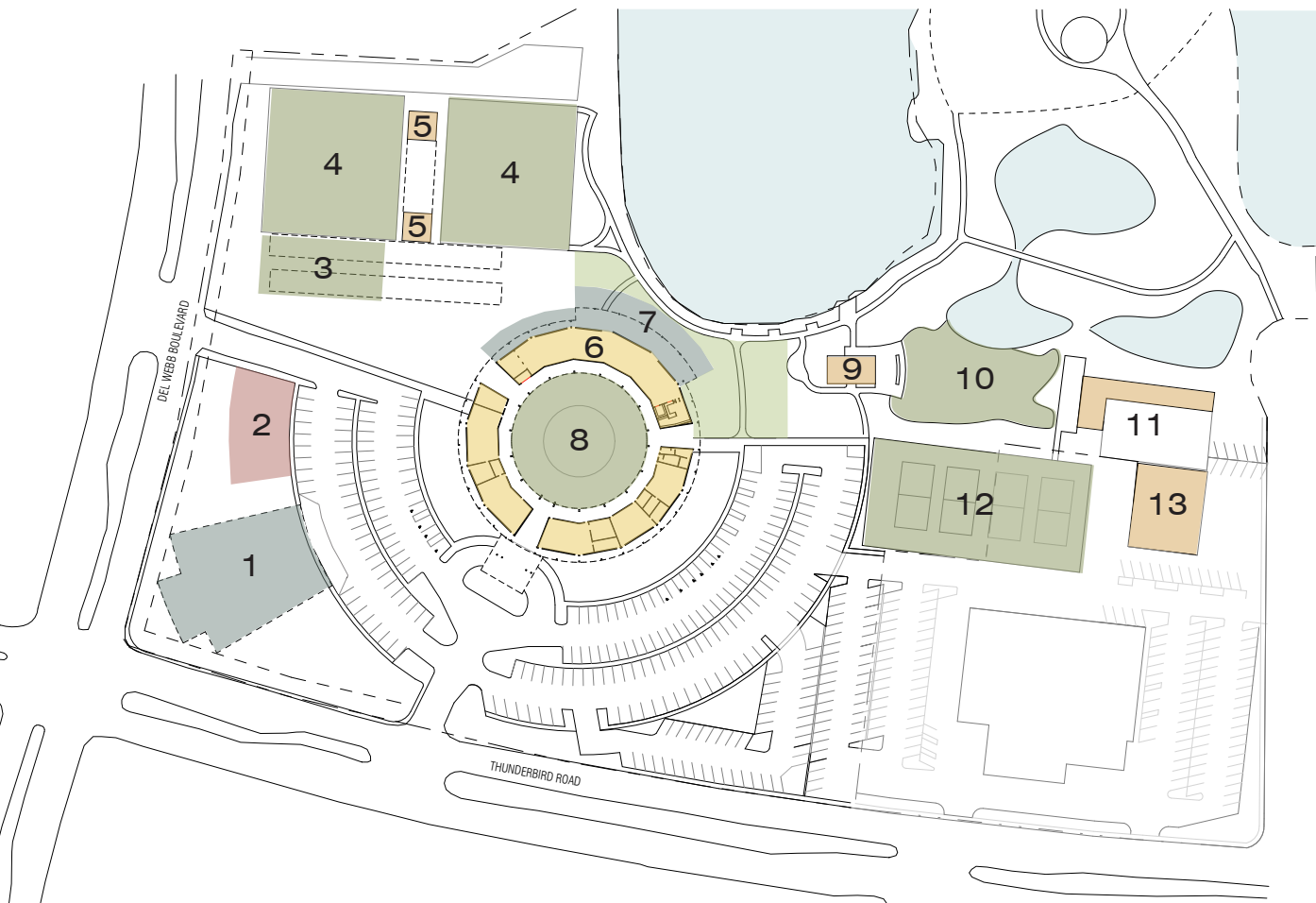

**PROJECT KEY**

- 1 New performing arts center, approx. 20,000 sf
- 2 New parking area for displaced parking from PAC
- 3 Shuffleboard to remain
- 4 Lawn bowling to remain
- 5 Existing lawn bowling buildings to remain
- 6 Existing recreation center to be renovated
- 7 New lake focused addition zone
- 8 Existing location of pool to remain - see plans for more
- 9 Existing mini golf building to remain
- 10 Existing mini golf course to remain
- 11 Existing building to remain
- 12 Existing tennis courts to be refurbished
- 13 Existing storage building to remain

- Existing building to remain
- Existing building to be renovated
- New proposed structure zone
- Existing site amenity to remain
- New site amenity zone
- New parking zone

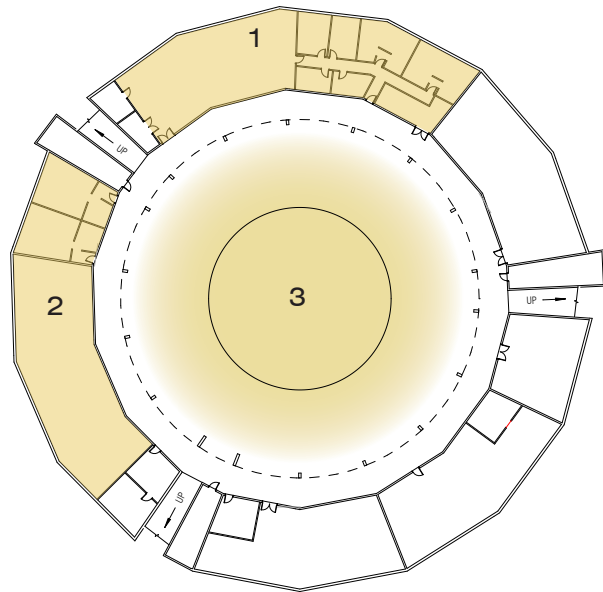

LOWER LEVEL FLOOR PLAN  
NTS

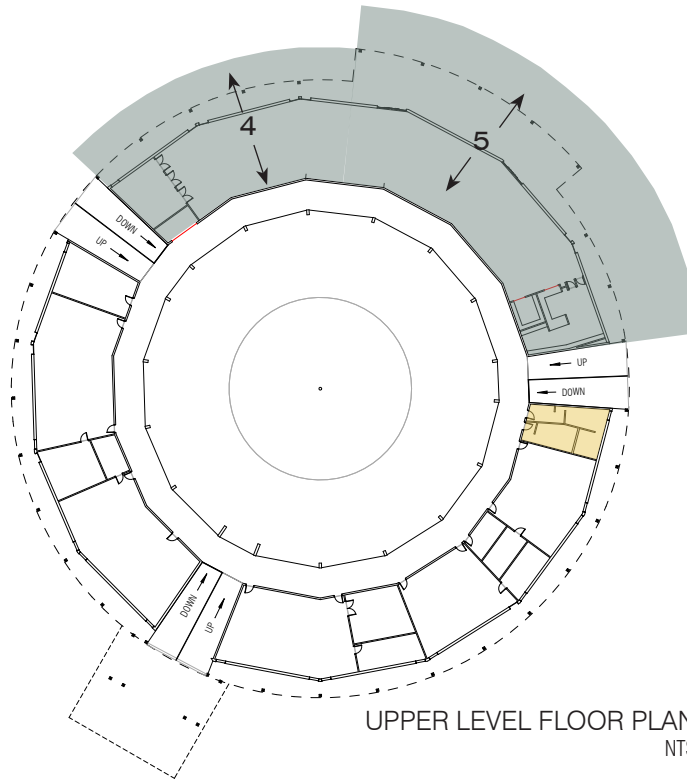

UPPER LEVEL FLOOR PLAN  
NTS

## LAKEVIEW RECREATION CENTER RENOVATION AND ADDITION ZONES

The Lakeview Recreation Center will be renovated and added on to in order to create the spaces necessary to provide for the site priority uses. This will include creating a new outdoor spa that is connected to the renovated pool area, appropriately sizing and proportioning a fitness zone with renovated and added space, creating a more appropriately sized and proportioned social space focused on the lake, and renovating the existing locker / shower / and restroom areas.

### Renovation areas:

8,850 SF Lower Level Restrooms / Showers  
23,000 SF Pool Area (outdoor)

600 SF Restroom Renovations  
17,600 Sf Major Renovation / Addition

### PROJECT KEY

- 1 Existing indoor spa to be renovated to exterior space
- 2 Existing showers / restrooms to be renovated
- 3 Existing pool area to be renovated
- 4 New fitness zone
- 5 New social zone and visitor's center

Existing building to be renovated

New proposed structure zone