

LAKEVIEW AND MOUNTAIN VIEW SITE USE

09.01.2023 Committee Review Lakeview Priorities

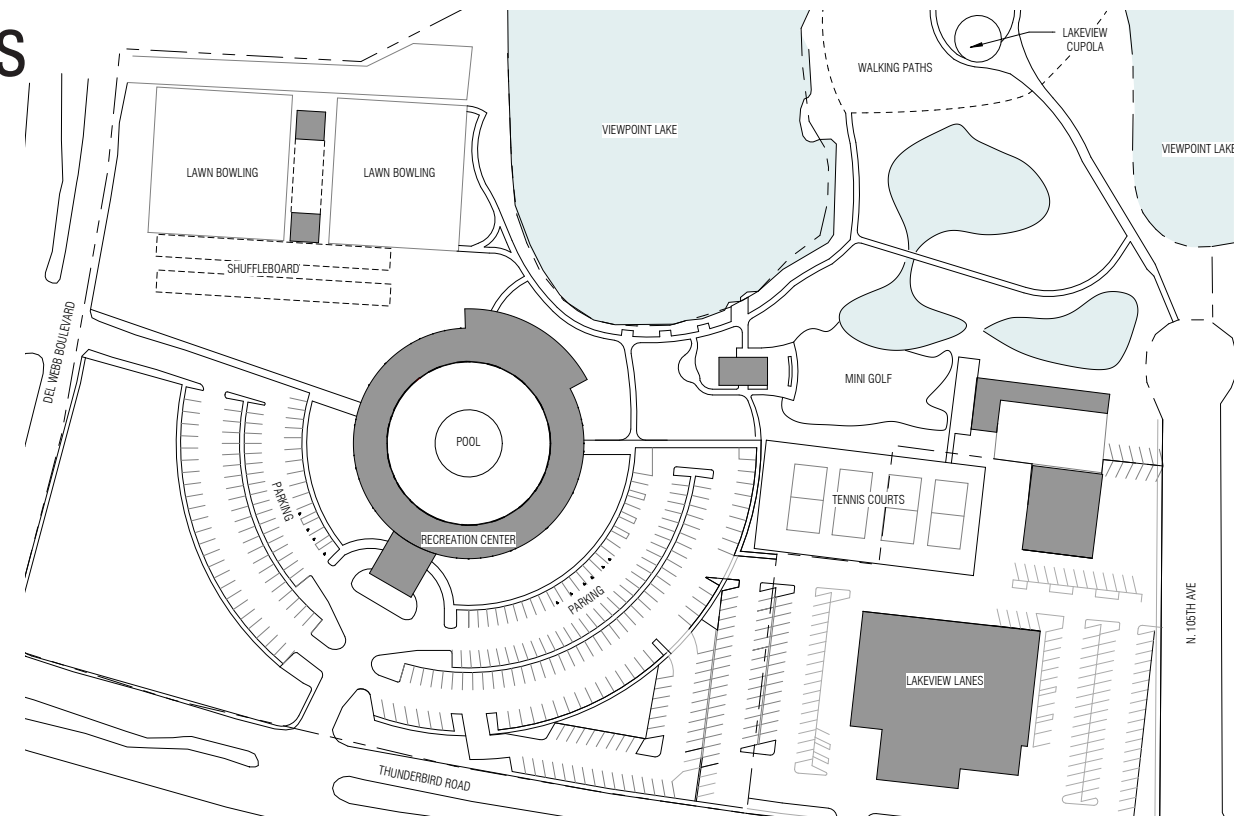

MASTER PLAN EXAMPLE



PROPOSED PROJECTS

PROJECT LIST	
Measure Name	ID No.
Library/ Campus Center (begun after completion of Project E)	A
Business and Computer Technology (begun after replacement of Measure D4)	B
Athletic Concessions and Restrooms	D
Athletic Education Building (Includes Gynmasium)	D1
Pool (Athletic Education Building lower level)	D2
Team Room	D3
Tennis Courts (12 competition courts)	D4
Practice Fields	D5
Career and Technical Education Building Renovation	E
Kinesiology and Athletics	F1
Classroom Building Renovation	F2
Laboratory Building Expansion	G
Fire Training Academy	H
Public Transit Center	I
Parking Structure (2,300 spaces)	J
Demolish in Future: Old Gym (3), Student Life Center (9C), Liberal Arts 2 (16), Campus Inn (8) Row Buildings (17-21)	L4
Building 9A Renovation	L7-A
Building 12 Renovations	L7-B
Facilities Improvement Projects #1 - EOC/Facilities Plan Room	L7-C1
Facilities Improvement Projects #2 - Food Service	L7-C2
Facilities Improvement Projects #3 - Language Lab Expansion	L7-C3
Facilities Improvement Projects #4 - Student Support Services	L7-C8
Building 40 Continuing Education Remodel	L7-C15
Future Programs	
Future Instructional Building (35,000 sf)	1
Continuing Education Building (2 story)	2
Auditorium (1,200 seat)	3
Future Instructional Building Zone	4
Future Instructional Building Zone	5
Future Instructional Building Zone	6

LEGEND

FUTURE NEW BUILDING OR EXPANSION ZONE

EXISTING BUILDING - TO BE RENOVATED UNDER RR

EXISTING BUILDING - DEMOLITION

EXISTING BUILDING - TO REMAIN

FUTURE PROGRAM ZONE

A

 PROJECT ID

*Projects not in prioritized order

PROPOSED SCHEDULE

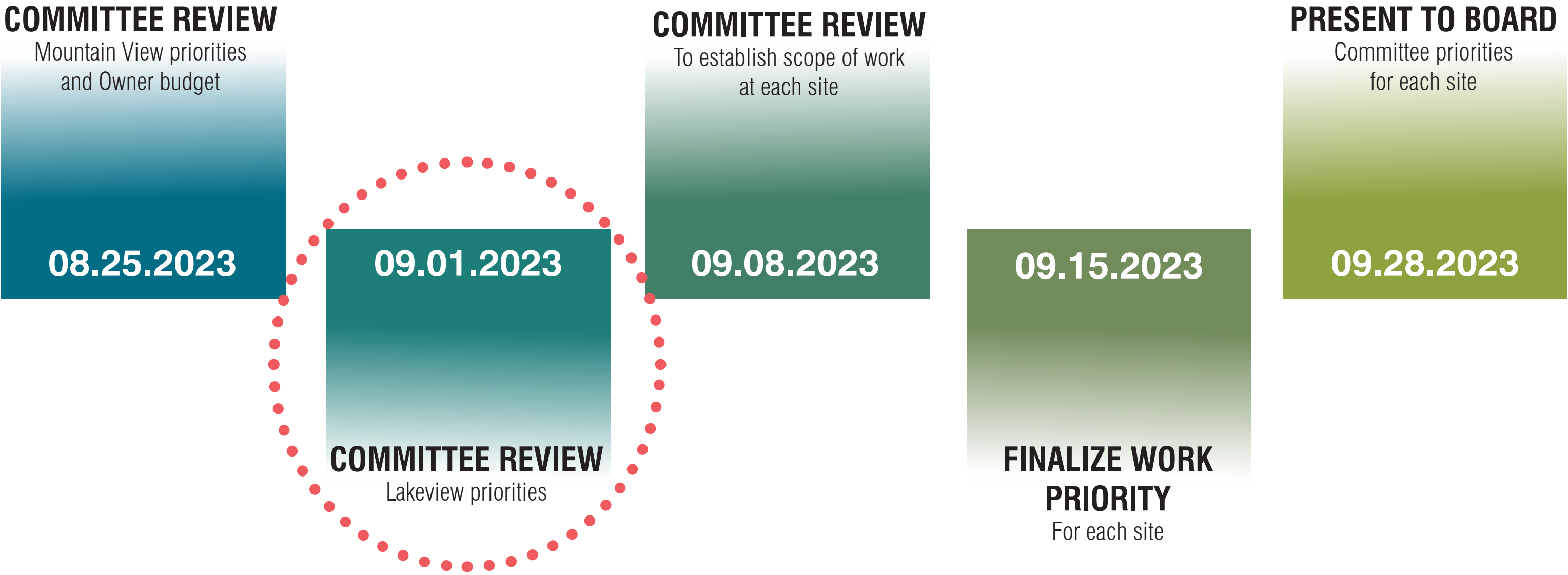

COMMITTEE REVIEW

Mountain View priorities
and Owner budget

08.25.2023

OUTCOMES

PRIORITIES AT MOUNTAIN VIEW

OUTDOOR SPA
- SHADED

PICKLEBALL
- 7 EXIST EXTERIOR
- 1+ DESIRED
- 12 MINIMUM REQD FOR CLUB ACT'S.

SWIMMING
2 POOLS
- RESORT/AQUA FITNESS
- SPORT LANE & SPORT

HORSESHOES/
CORNHOLE AREA
- 1

- SHADED > 50%
- VENTED

TENNIS
- RETAIN AT M. VIEW
- 2 COURTS OK
- REPAIR NEEDED

INDOOR
- NOISE REDUCTION
- CLIMATE COND'N

MINI GOLF

LAWN BOWLING
- RETAIN

FITNESS CENTER
- 2X EXISTING

PRIORITIES FOR COMMUNITY

BUDG IS NOT
AREH. STRONG

AUDITORIUM/
PERFORMING/ARTS
- STEPPED SEATING
- 300 SEATS
- STAGE
- DRESSING

- MAKEUP
- ACCESS TO SEPARATE REHEARSAL
- GREEN RM
- STORAGE: REUS. EQUIP.

WATER VOLEYBALL
- OAKMONT IS PREFERRED
- W/ ADDED SHADE
- FURNITURE/STORAGE

- REGULATION
LAP POOL 3 LANE

MULTI-PURPOSE
ACTIVITY
~~NO~~ OPTION?

PRIORITIES AT MOUNTAIN VIEW

- OUTDOOR SPA
- HORSESHOES / CORNHOLE AREA
- MINI GOLF (RETAIN)
- LAWN BOWLING (RETAIN)
- FITNESS CENTER (2X EXISTING)
- PICKLEBALL
 - 12 MINIMUM, 14 PREFERRED, 50% SHADED / VENTED
- SWIMMING
 - RESORT / AQUA FITNESS POOL
 - LAP / SPORT POOL
- TENNIS (2 COURTS)

PRIORITIES FOR COMMUNITY - LOCATION TBD

- PERFORMING ARTS CENTER (20,000 SF)
 - 300 SEATS WITH STEPPED SEATING
 - STAGE
 - DRESSING ROOMS & MAKE UP ROOMS
 - GREEN ROOM
 - ACCESS TO SEPARATE REHEARSAL SPACE
 - STORAGE (RISERS / EQUIPMENT)

OPTIONS

- MULTI PURPOSE ACTIVITY SPACE

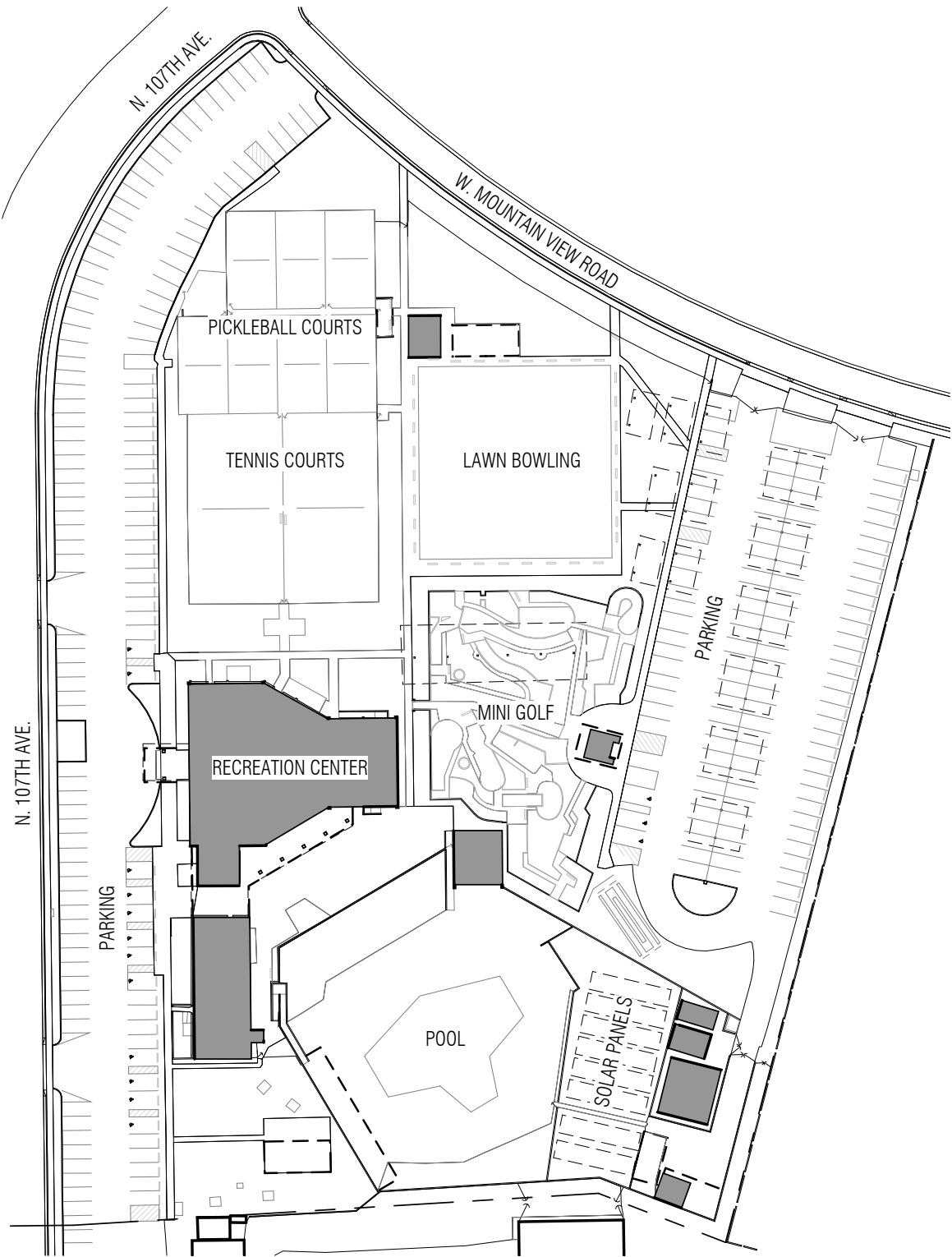

SITE PLAN - MOUNTAIN VIEW
Scale: 1" = 100'

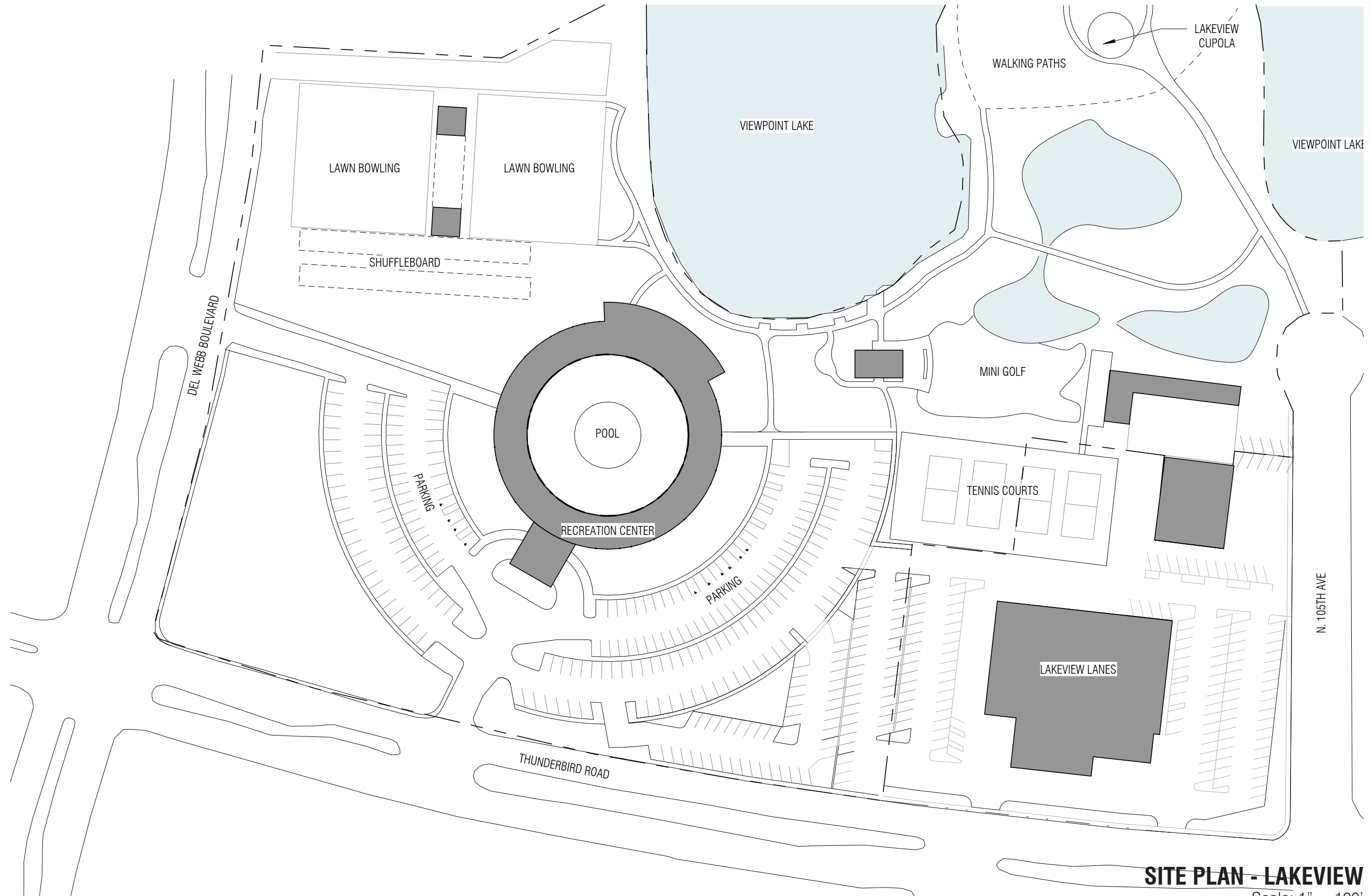

SITE PLAN - LAKEVIEW

Scale: 1" = 100'

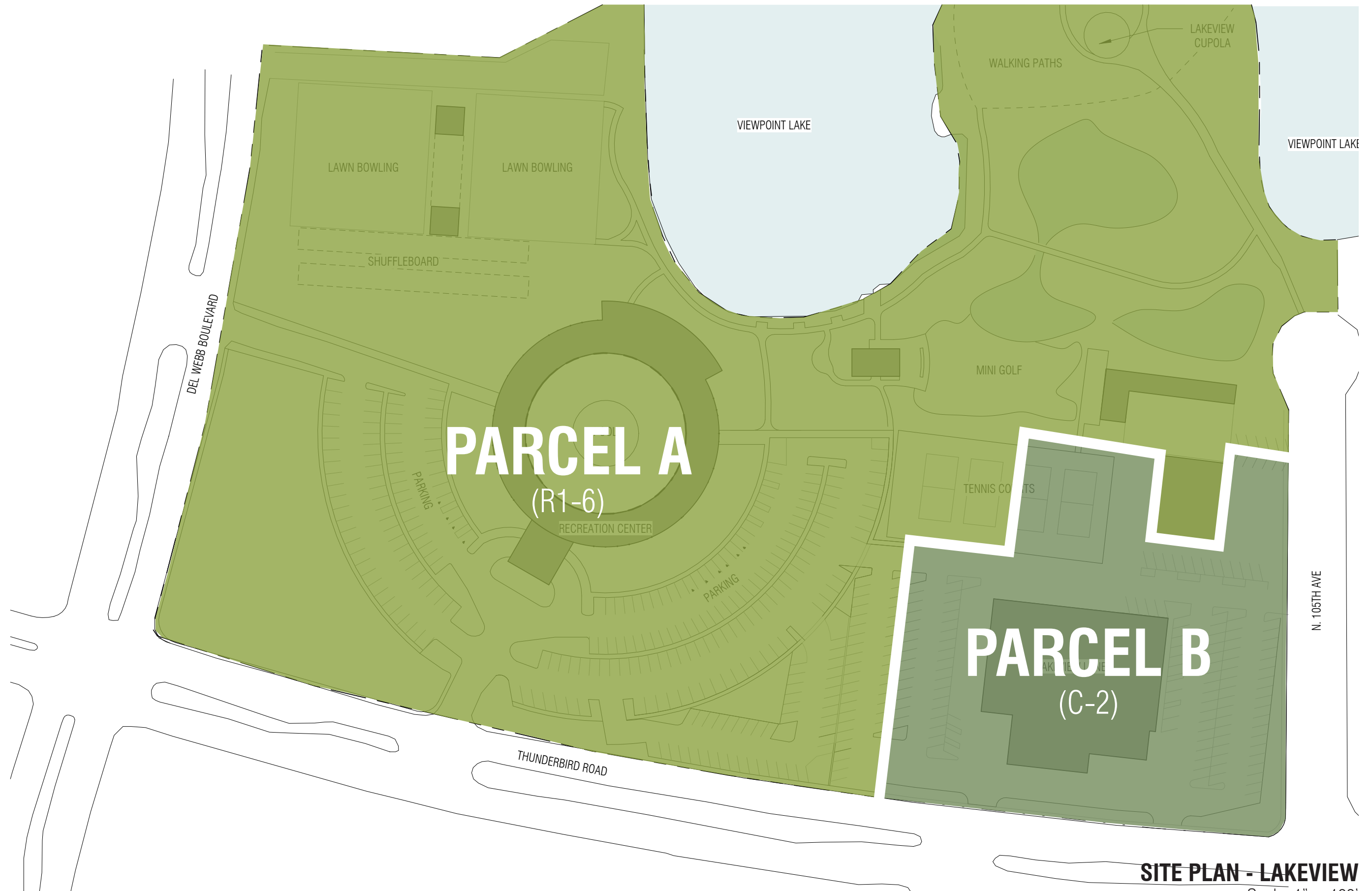

SITE PLAN - LAKEVIEW

Scale: 1" = 100'

OUTDOOR ACTIVITY SPACES

- A. SWIMMING POOL (1)
- B. TENNIS COURTS (4)
- C. SHUFFLEBOARD COURTS (12)
- D. LAWN BOWLING (2 GREENS)
- E. MINI GOLF

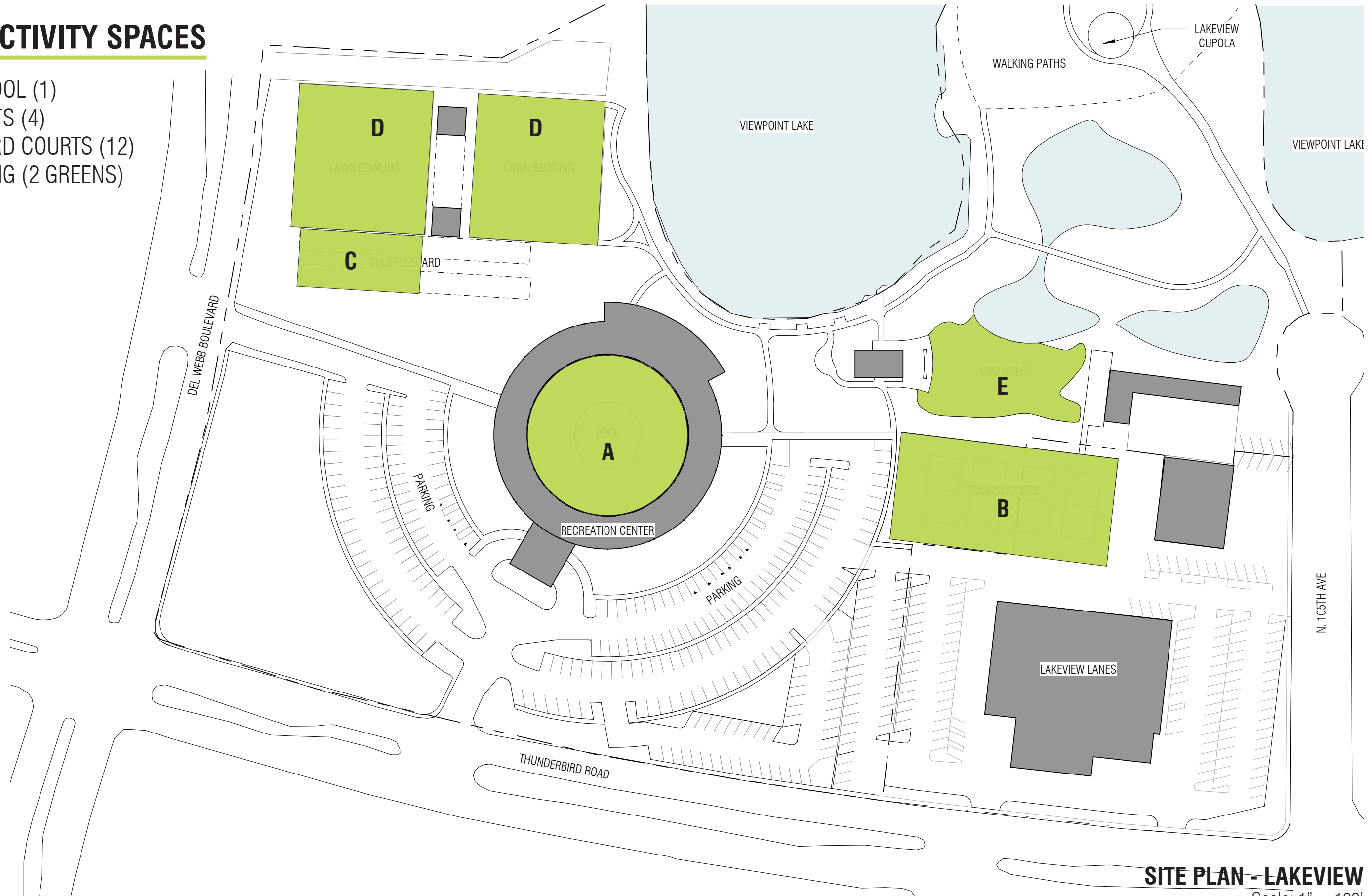

SITE PLAN - LAKEVIEW

Scale: 1" = 100'

PARKING COUNTS

WEST LOTS
82 SPACES, INCL. 4 ACCESSIBLE

EAST LOTS
208 SPACES, INCL. 6 ACCESSIBLE

TOTAL PROVIDED: 290 SPACES

LAKEVIEW LANES
EXISTING PARKING TO REMAIN

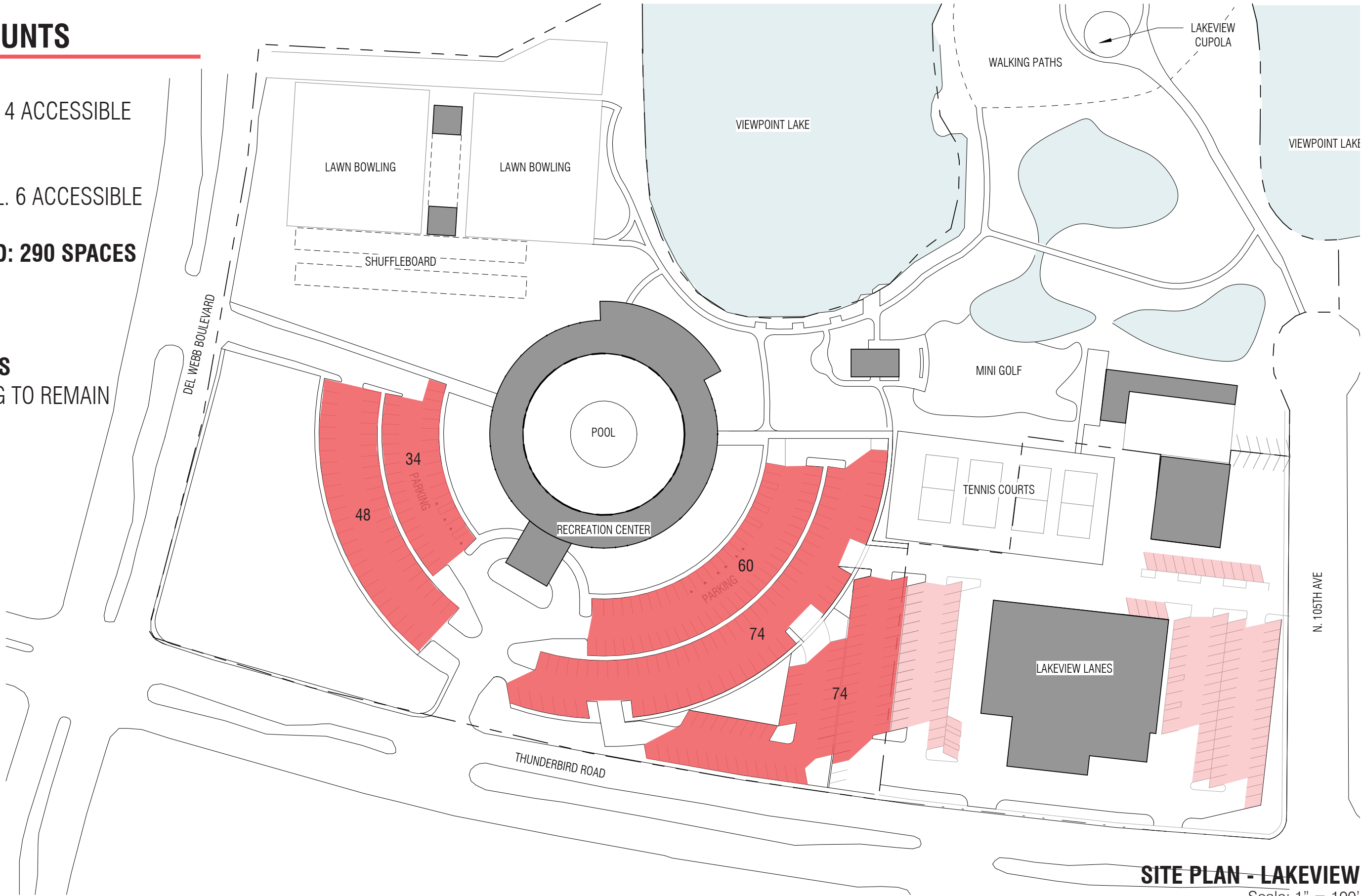

SITE PLAN - LAKEVIEW
Scale: 1" = 100'

PEDESTRIAN CIRCULATION

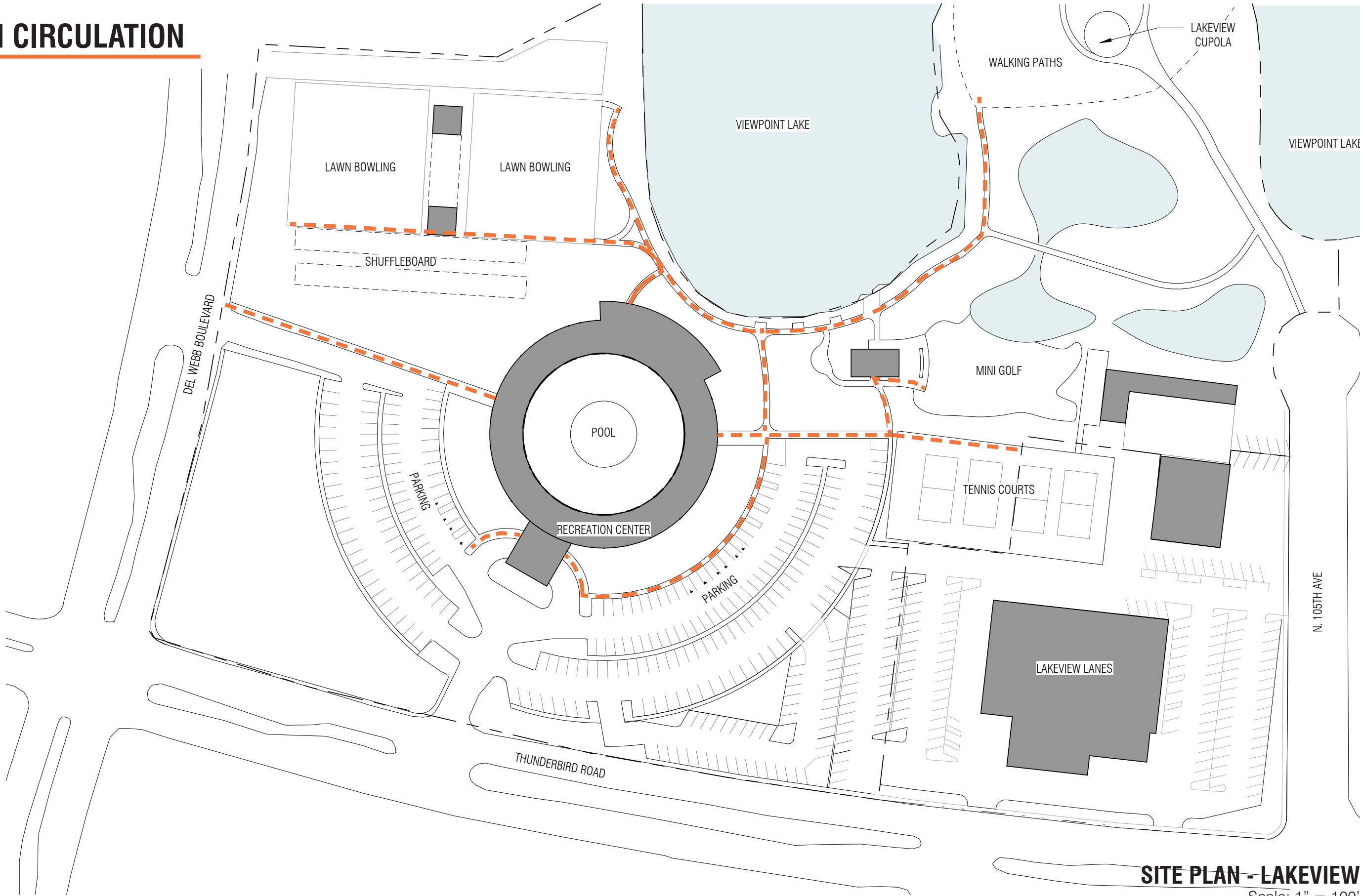

LAKEVIEW MEMBER USE DATA

	JAN	FEB	MAR	APR	MAY
BILLIARDS TOTAL	775	793	909	692	683
<i>Billiards - General</i>	407	438	453	382	347
<i>Billiards Club</i>	368	355	456	310	336
ROW BOAT	31	24	17	19	15
PEDAL BOAT	189	606	959	584	303
FISHING	330	200	251	219	180
FITNESS TOTAL	918	884	968	782	747
<i>Fitness - General</i>	918	884	968	782	747
<i>Fitness - Get Fit for Life with Dick & Jane</i>	-	-	-	-	-
MINI GOLF TOTAL	1,673	2,079	2,842	1,698	616
<i>Mini Golf - General</i>	1,673	2,079	2,830	1,659	616
<i>Mini Golf - Club</i>	-	-	12	39	-
SWIM POOL TOTAL	1,026	1,565	3,059	3,872	2,250
<i>Swim Pool - General</i>	984	1,445	2,692	3,543	2,149
<i>Swim Pool - Children</i>	42	120	367	286	84
<i>Swim - Club</i>	-	-	-	43	17
INDOOR SPA	774	746	788	599	370
TENNIS COURTS	83	112	138	107	68
WALKERS AT HILLSIDE PAR	4,346	4,643	6,267	4,647	2,575
LAKEVIEW TOTAL	10,145	11,652	16,198	13,219	7,807

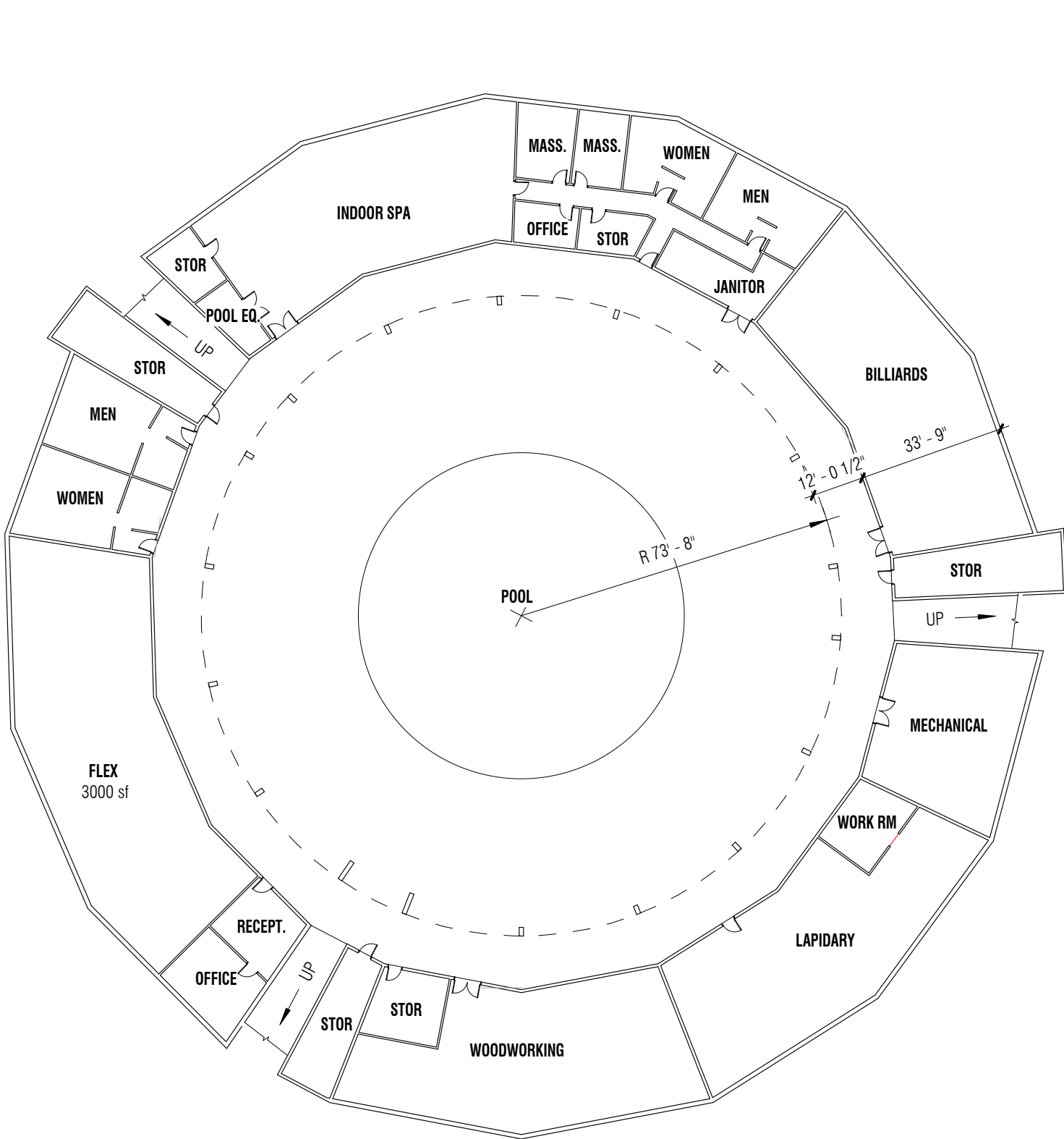

LOWER LEVEL FLOOR PLAN

SCALE: 1/32" = 1'-0"

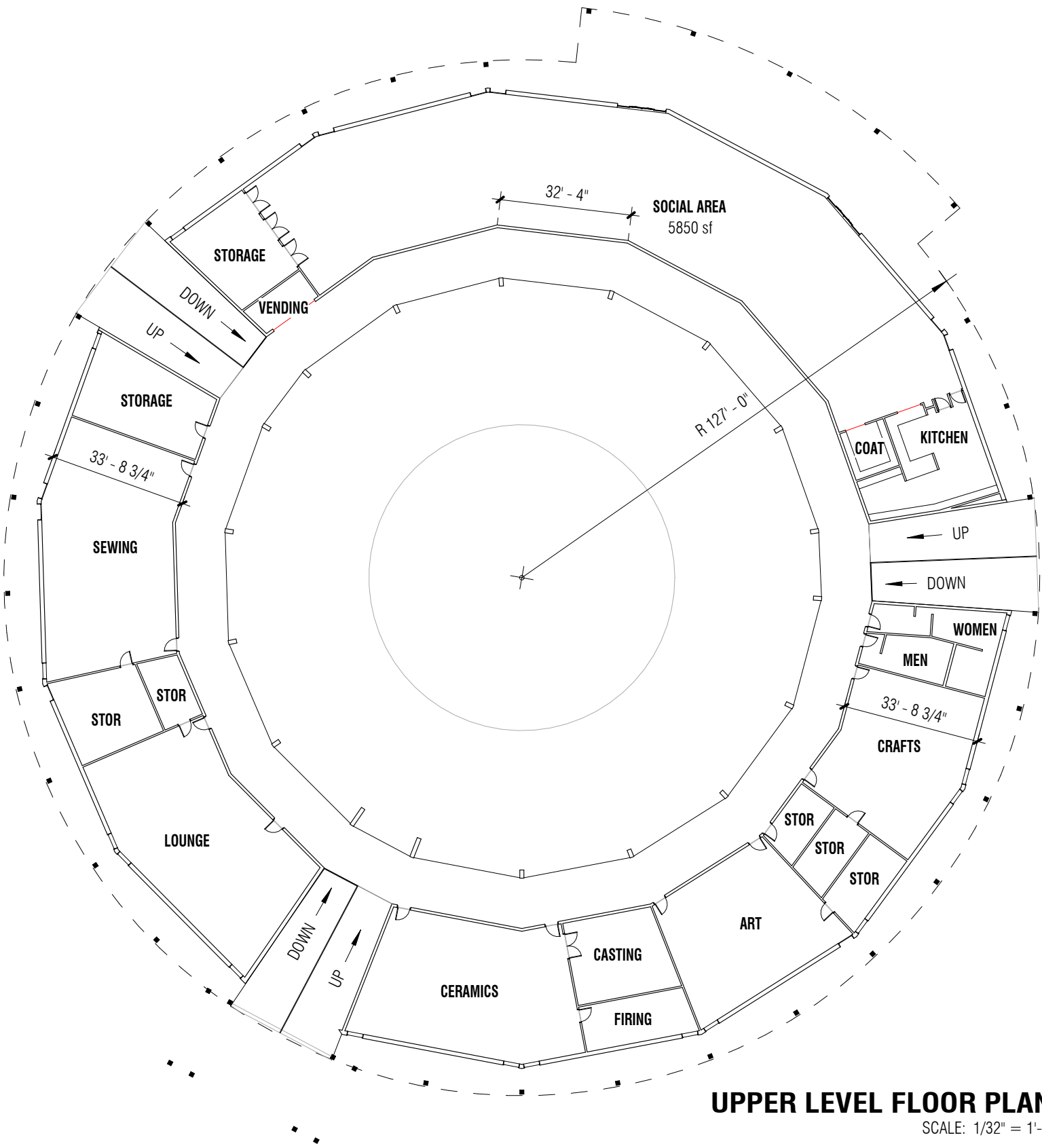

UPPER LEVEL FLOOR PLAN

SCALE: 1/32" = 1'-0"

OVERALL SQUARE FOOTAGE
 18,325 SF LOWER LEVEL
 18,325 SF UPPER LEVEL
 TOTAL: 36,650 SF























W Buccaneer Way

N DEL

SUN CITY 16
MGR 122-03

200-84-025A

200-84-025A

200-84-025A

W THUNDERBIRD BLVD

N 105th Ave

200-84-032A

200-84-032A

200-84-026P

200-84-026P

200-85-491C

SUN CITY
200-84-119-10
MGR 119-10

200-85-451

200-85-888
200-85-889

200-84-962

Th Dr